

EL ALEPH

YACHT INFORMATION



RASCAL
VOYAGES

LAUNCH YOURSELF INTO AN OFF-THE-GRID ADVENTURE WITH NO COMPROMISE ON LUXURY



El Aleph is a traditional handmade phinisi yacht built in 2008 in Serangan, Indonesia. Measuring 39m in length, she accommodates up to 10 guests across five cabins and features generous indoor and outdoor living areas, including an expansive main deck for sunbathing by day and alfresco dining by night. Refurbished by Rascal Voyages in 2025, her interiors have been reimagined with lighter teak, curated antiques, and handwoven textures, blending timeless Indonesian heritage with Rascal's signature Archipelago Chic aesthetic.





FLOOR PLANS

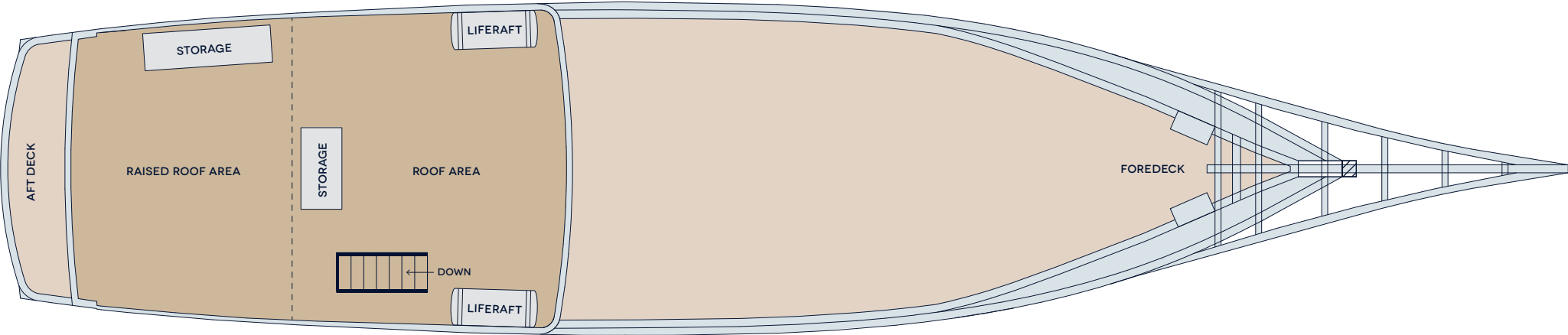

ROOF DECK

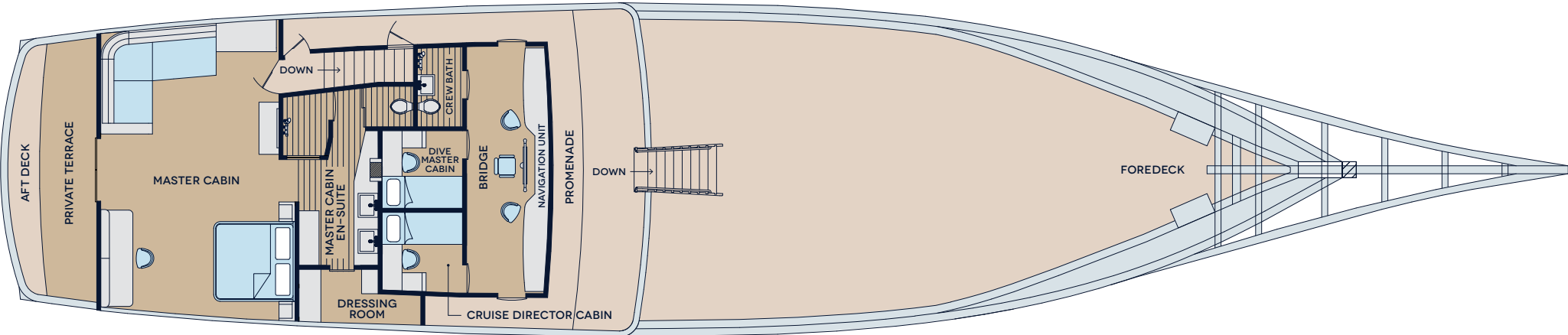

UPPER DECK





FLOOR PLANS

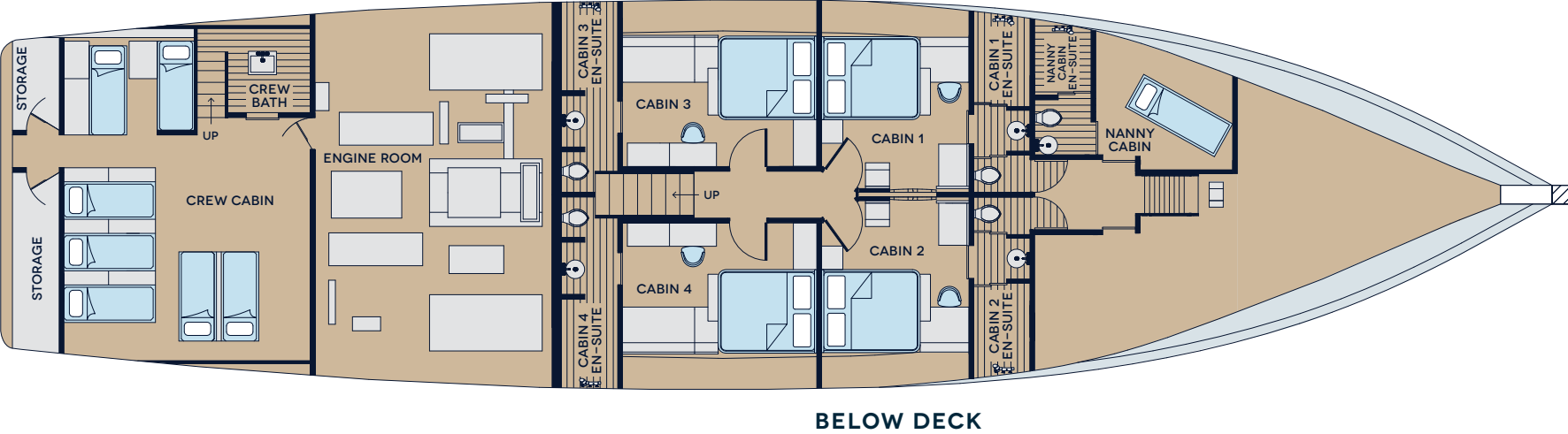
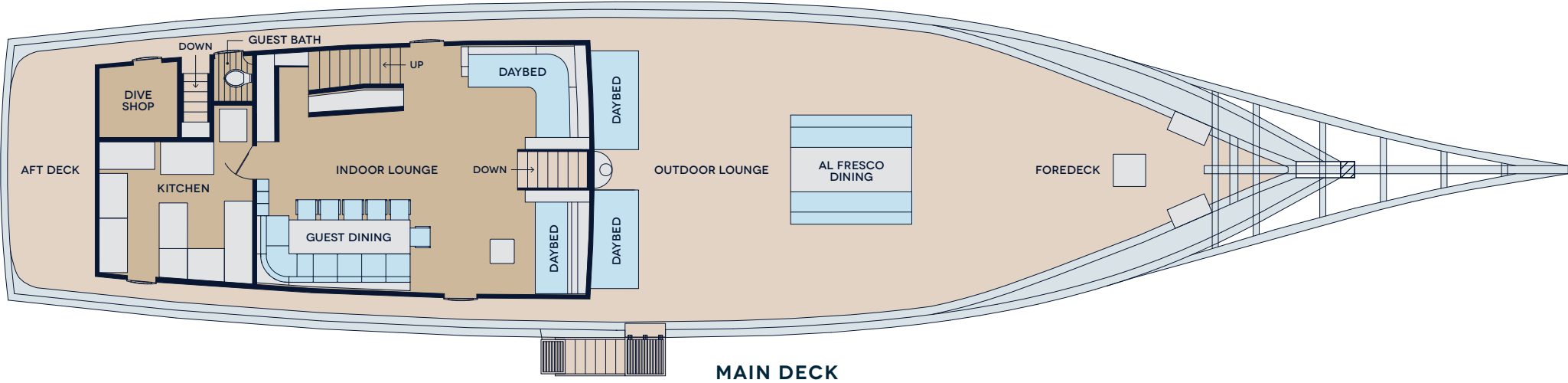

YACHT SPECIFICATIONS

- LOA: 39 Metres
- Draft: 3.4 Metres
- Beam: 9 Metres
- Builders: Konjo Boat Builders of Tana Beru Village
- Built: 2008, interior refit 2025
- Hull Construction: Ironwood
- Two inflatable tenders
- 5 cabins with en-suite bathrooms
- Guest: 10
- Crew: 13
- Air Conditioning
- WiFi

ON-DECK

- 5 spacious deck areas
- Convertible sunbathing lounge



EQUIPMENT

- Full scuba equipment and onboard PADI dive instructor
- Snorkelling equipment
- Kayaks x 4
- Stand up paddleboards x 4
- Inflatable towable mattress
- Wakeboard
- Water skis
- Fishing equipment
- Banana boat
- Board and card games

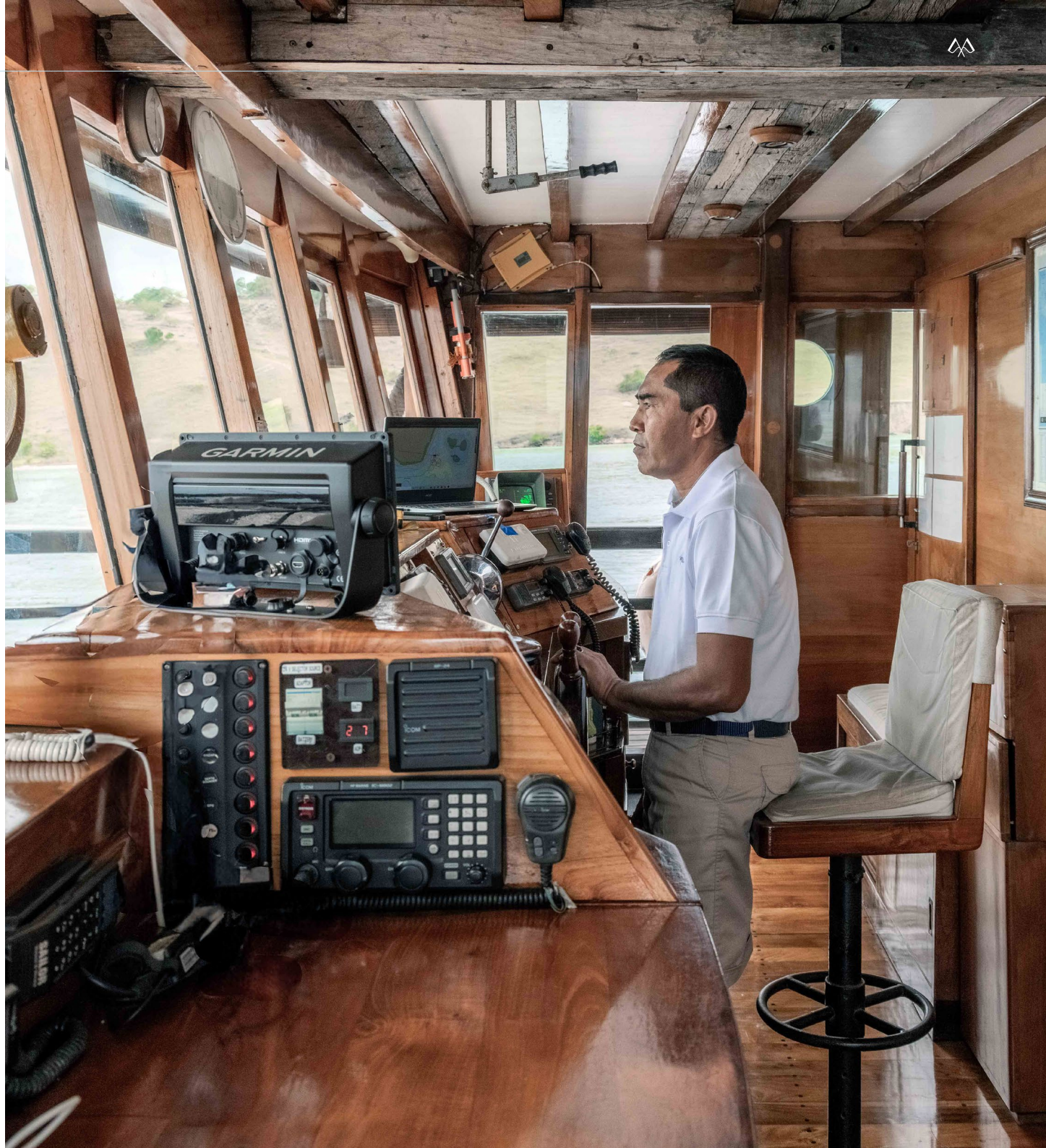

ACTIVITIES



DECK YOGA



MASSAGE



COOKING CLASS



SNORKELLING



KAYAKING



PADDLEBOARDING



**DIVING AND
CERTIFICATION**



**WILDLIFE
WATCHING**



**POP-UP
BEACH CLUB**



**POP-UP BEACH
RESTAURANT**



**NAVIGATION
CLASS WITH THE
CAPTAIN**



**VILLAGE
AND MARKET
TOURS**

Cooking class, massage, yoga and diving certification upon request.





MASTER CABIN

UPPER DECK

- El Aleph's largest cabin and only one above deck
- Super King sized bed + additional daybed
- Wraparound windows
- En-suite bathroom
- Walk-in wardrobe
- Large desk
- Private balcony
- Air Conditioning
- Cabin size: 7.5m x 4m
- Bed size: 200 x 200cm
- Ceiling height: 2.56m

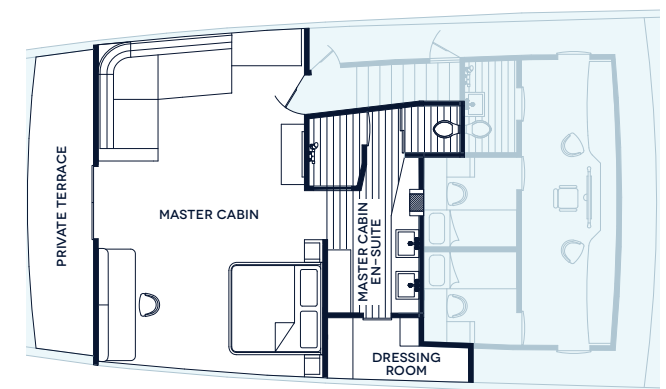

CABIN 4

BELOW DECK

- Queen sized bed + additional daybed
- En-suite bathroom
- Desk
- Air Conditioning
- Cabin size: 4.1m × 2.8m
- Bed size: 160 x 200cm
- Ceiling height: 2.38m

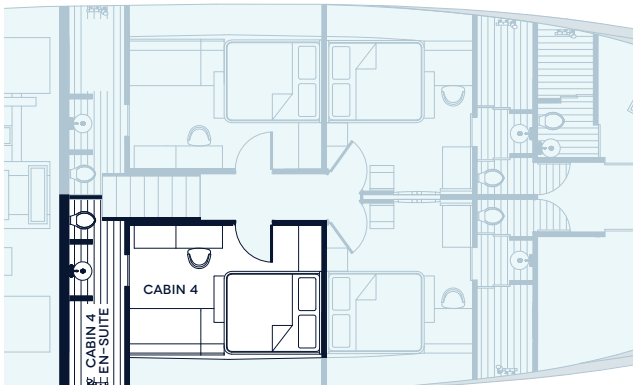



CABIN 3

BELOW DECK

- Queen sized bed + additional daybed
- En-suite bathroom
- Desk
- Air Conditioning
- Cabin size: 4.1m x 2.8m
- Bed size: 160 x 200cm
- Ceiling height: 2.38m

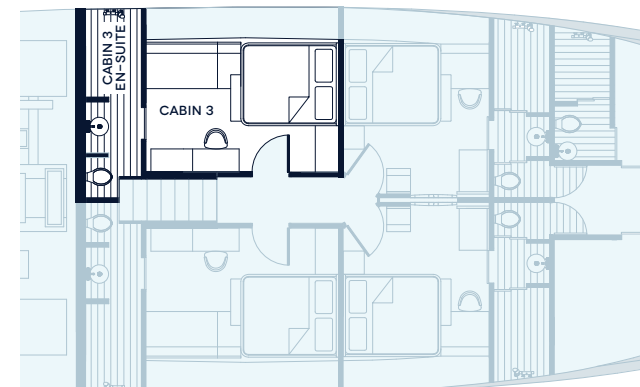

CABIN 2

BELOW DECK

- Queen or Twin sized bed set-ups
- Twin rooms can be interconnected
- Desk
- En-suite bathroom
- Air Conditioning
- Cabin size: 3.14m x 2.85m
- Bed size: One side - 87 x 200cm
Two sides together - 174 x 200cm
- Ceiling height: 2.35m

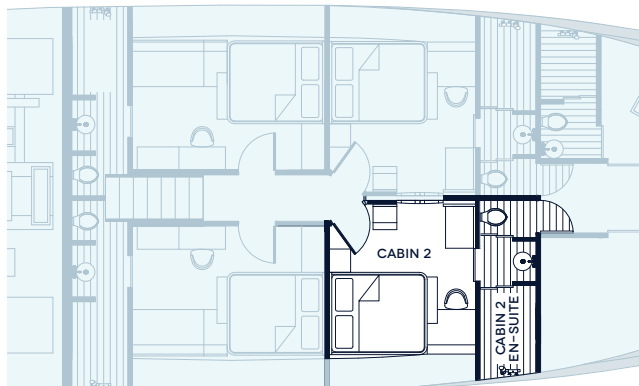



CABIN 1

BELOW DECK

- Queen or Twin sized bed set-ups
- Twin rooms can be interconnected
- Desk
- En-suite bathroom
- Air Conditioning
- Cabin size: 3.14m x 2.85m
- Bed size: One side - 87 x 200cm
Two sides together - 17 x 200cm
- Ceiling height: 2.35m

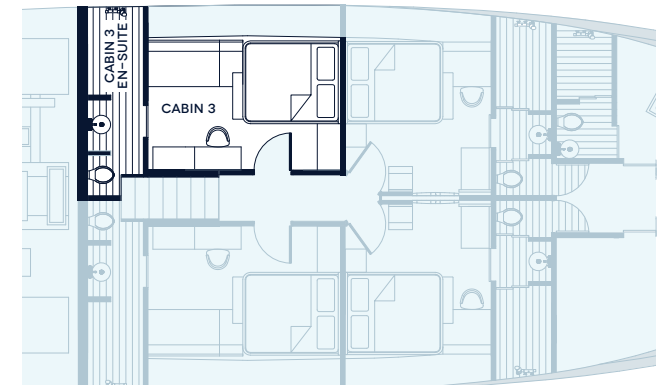

FOREDECK BY THE BRIDGE

Uninterrupted views of the
sea and landscape.





SALOON – INSIDE DINING

Spacious, cool and sheltered –
comfortably seats 10 people.

SALOON – LOUNGE

The perfect place to unwind and relax –
air conditioned and airy.



MAIN DECK – DINING AREA

A large sheltered open air space,
designed for alfresco dining.

MAIN DECK – SUN LOUNGE

A large space ideal for socialising, sunbathing and taking in the sea and landscapes.





RASCALVOYAGES.COM

For more information contact Sharifah Khadijah, Head of Sales & Customer Delight at +65 8785 3122 or enquiries@rascalvoyages.com